

Pull handle heavy straight

Knud Holscher collection

Product

1301-1500mm, bush M10.

Tender text

Knud Holscher collection, pull handle 20, straight, 1301-1500mm, bush. Manufactured in the highest quality marine grade, AISI 316 stainless steel, protecting against high levels of corrosion. Certified in accordance with EN 1906 to ---B----, 20-year warranty.

Product specification

Dimensions: O/A: 1301-1500mm, B: 80mm, C/C: 1141-1340mm, 20x75mm.
Diameter: Ø20mm
Material: stainless steel AISI 316
Surface finish: satin grain 320, crafted by hand
[20-year warranty \(5 years for coated items\)](#)

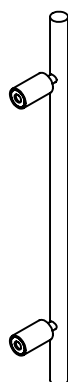
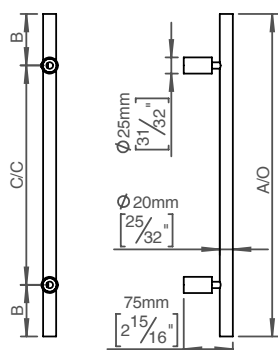

Available finishes

Solid metal



Satin steel

Polished steel

PVD



Charcoal

Gunmetal

Copper

Brass

Powder coated



White

Black

Pale telegrey

Grey



Super matt black

Super matt white

Spare parts/ accessories

14491792303 - Bush head bolt M12x30mm
14491792605 - Bush head bolt M12x60mm
14491792609 - Bush head bolt M12x100mm

Mounting

<https://dline.com/mounting-instructions/>

Product care

d line products are produced in the highest quality marine grade AISI 316 stainless steel. To sustain the unique d line finish please follow the below instructions:

- Wash down the surfaces using soapy water or mild detergent
- Always thoroughly rinse off with clean water
- To complete the cleaning procedure dry/polish the surface with a soft dry cloth

Please do not use scouring powder, steel wool, chloride based detergents or other aggressive cleaning products as these may damage the surface.

If spots or corrosion appear on the surface it is not due to the stainless steel quality, but to impurities in the environment, aggressive conditions or improper or insufficient cleaning.