

# Senkschrauben mit Schlitz Messing

Slotted countersunk (flat)  
head screws  
Vis à tête fraisée, en laiton

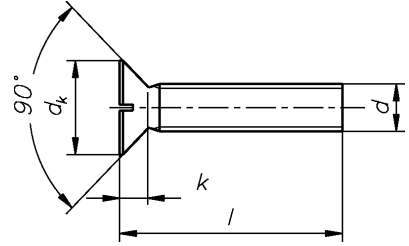

**DIN 963** DIN-EN-ISO 2009

d	M 3	M 4	M 5	M 6	M 8
dk	5,6	7,5	9,2	11	14,5
k	1,65	2,2	2,5	3	4

## WGR 3133 000

d mm	l mm	Inhalt Stck	€ 100 Stck
M 3	6,0	100	2,76
M 3	8,0	100	2,76
M 3	10,0	100	2,84
M 3	12,0	100	2,96
M 3	16,0	100	3,36
M 3	20,0	100	3,84
M 3	25,0	100	4,32
M 3	30,0	100	5,88
M 3	35,0	100	6,12
M 3	40,0	100	8,32
M 3	45,0	100	11,04
M 3	50,0	100	13,32
M 4	6,0	100	3,88
M 4	8,0	100	3,88
M 4	10,0	100	4,12
M 4	12,0	100	4,12
M 4	16,0	100	4,92
M 4	20,0	100	5,72
M 4	25,0	100	6,04
M 4	30,0	100	7,08
M 4	35,0	100	7,92
M 4	40,0	100	8,56
M 4	45,0	100	10,44
M 4	50,0	100	11,88
M 4	60,0	100	20,44
M 5	6,0	100	5,84
M 5	8,0	100	5,84
M 5	10,0	100	5,96
M 5	12,0	100	6,20
M 5	16,0	100	7,04
M 5	20,0	100	7,72

d mm	l mm	Inhalt Stck	€ 100 Stck
M 5	25,0	100	8,64
M 5	30,0	100	10,20
M 5	35,0	100	13,40
M 5	40,0	100	14,00
M 5	45,0	100	15,84
M 5	50,0	100	16,08
M 5	55,0	50	19,52
M 5	60,0	50	21,00
M 5	70,0	50	25,48
M 5	80,0	50	31,72
M 6	8,0	100	8,04
M 6	10,0	100	8,04
M 6	12,0	100	9,08
M 6	16,0	100	10,32
M 6	20,0	100	11,40
M 6	25,0	100	12,08
M 6	30,0	100	14,44
M 6	35,0	100	16,36
M 6	40,0	100	17,76
M 6	45,0	50	20,84
M 6	50,0	50	21,76
M 6	60,0	50	27,36
M 6	70,0	50	32,48
M 6	80,0	50	34,92
M 6	90,0	25	43,44
M 6	100,0	25	51,44
M 8	16,0	100	23,00
M 8	20,0	100	24,56
M 8	25,0	50	26,16
M 8	30,0	50	29,68
M 8	35,0	50	31,84

## Senkschrauben mit Schlitz Messing

Slotted countersunk (flat)  
head screws  
Vis à tête fraisée, en laiton

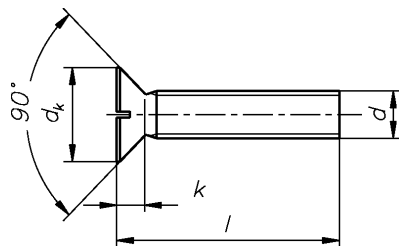

**DIN 963** DIN-EN-ISO 2009

### WGR 3133 000

d mm	l mm	Inhalt Stck	€ 100 Stck
M 8	40,0	50	33,84
M 8	45,0	50	39,04
M 8	50,0	25	41,68
M 8	60,0	25	50,52

d mm	l mm	Inhalt Stck	€ 100 Stck
M 8	70,0	25	61,20
M 8	80,0	25	65,64
M 8	90,0	25	77,44
M 8	100,0	25	88,64

### WGR 3133

**074** vernickelt • nickel-plated • nickelé

d mm	l mm	Inhalt Stck	€ 100 Stck
M 3	6,0	100	3,12
M 3	8,0	100	3,12
M 3	10,0	100	3,28
M 3	12,0	100	3,40
M 4	10,0	100	4,52
M 4	12,0	100	4,60
M 4	16,0	100	5,40
M 4	20,0	100	6,24

d mm	l mm	Inhalt Stck	€ 100 Stck
M 4	25,0	100	6,64
M 5	12,0	100	6,76
M 5	16,0	100	7,80
M 5	20,0	100	8,60
M 5	25,0	100	9,72
M 5	30,0	100	11,20
M 5	35,0	100	14,60
M 5	40,0	100	15,48