

## Standard Installation of the body on hinge side

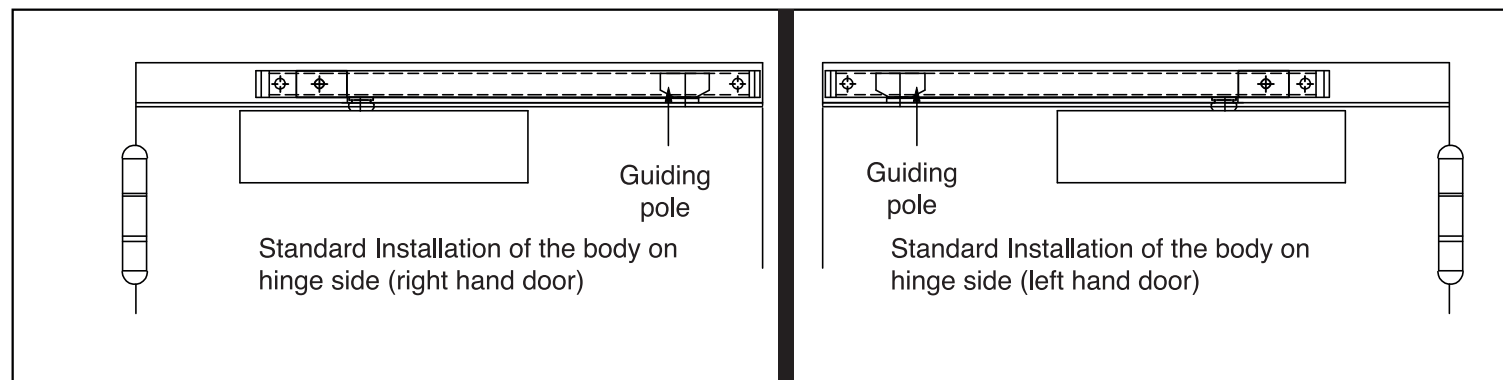

<b>CE</b>	<b>Union Euro Trading GmbH</b> Hermann-Buck-Weg 11-17, 22309 Hamburg, Germany	<b>21</b>
0905-CPR-210771-1 DoP: F6303BCG-1	EN1154:1996/A1:2002/AC:2006	4 8 3 1 1 4
Dangerous Substances: None		

Remark: Suitable for use on single leaf single action swing timber fire door. The fire resistance test was conducted with 836 mm width x 2040 mm height fire door in standard installation.



EN	Max. weight of door (kg)	Max. width of door (mm)
EN 3 fixe	65	1050

Be careful and do not to use a screwdriver to adjust the valves.  
Do not completely loose the valves = there is a risk of leakage / damage to the goods

<b>1</b> Using the installation dimensions, take the measurements 	<b>2</b> Install the door closer body first 	<b>3</b> Install the arm. Attach the cover before locking the guiding poles 	<b>1</b> Using the installation dimensions, take the measurements 	<b>2</b> Install the door closer body first 	<b>3</b> Install the arm. Attach the cover before locking the guiding poles 												
<b>4</b> Connect the arm parallel to the body 	<b>5</b> Adjust control valves 	<table border="1"> <tr> <td>BC</td><td>Slowdown during opening</td></tr> <tr> <td>1</td><td>Speed of closing</td></tr> <tr> <td>2</td><td>Finishing blow</td></tr> </table>	BC	Slowdown during opening	1	Speed of closing	2	Finishing blow	<b>4</b> Connect the arm parallel to the body 	<b>5</b> Adjust control valves 	<table border="1"> <tr> <td>BC</td><td>Slowdown during opening</td></tr> <tr> <td>1</td><td>Speed of closing</td></tr> <tr> <td>2</td><td>Finishing blow</td></tr> </table>	BC	Slowdown during opening	1	Speed of closing	2	Finishing blow
BC	Slowdown during opening																
1	Speed of closing																
2	Finishing blow																
BC	Slowdown during opening																
1	Speed of closing																
2	Finishing blow																

## ADJUSTMENTS

<b>Speed of closing (1)</b> 	<b>Finishing blow (2)</b> <p>angel = staring from 15°</p>	<b>Slowdown during opening (BC)</b> <p>angel = staring from 65°</p>	<b>Speed of closing (1)</b> 	<b>Finishing blow (2)</b> <p>angel = staring from 15°</p>	<b>Slowdown during opening (BC)</b> <p>angel = staring from 65°</p>
---------------------------------	--	--	---------------------------------	--	--

## Installation of the body on the frame from the side opposite to the hinges



CE	Union Euro Trading GmbH Hermann-Buck-Weg 11-17, 22309 Hamburg, Germany	21
0905-CPR-210771-1 DoP: F6303BCG-1	EN1154:1996/A1:2002/AC:2006	4 8 3 1 1 4
Dangerous Substances: None		

Remark: Suitable for use on single leaf single action swing timber fire door. The fire resistance test was conducted with 836 mm width x 2040 mm height fire door in standard installation.

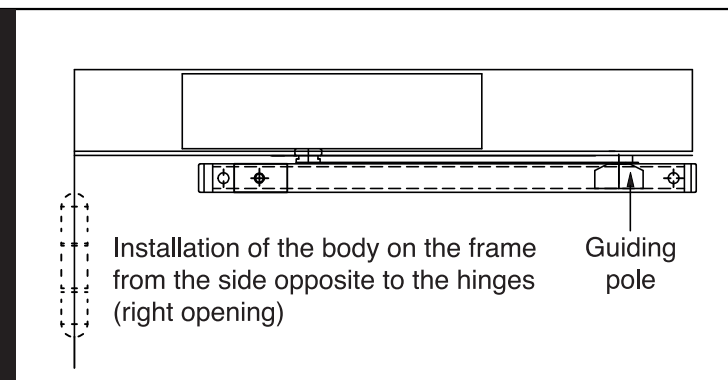
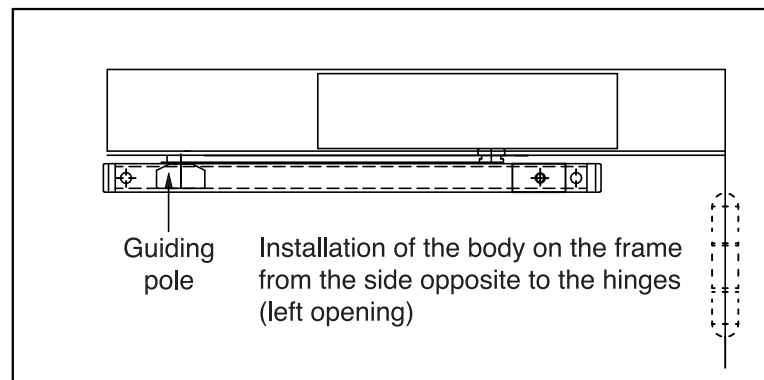

EN	Max. weight of door (kg)	Max. width of door (mm)
EN 3 fixe	65	1050

Be careful and do not to use a screwdriver to adjust the valves.  
Do not completely loose the valves = there is a risk of leakage / damage to the goods

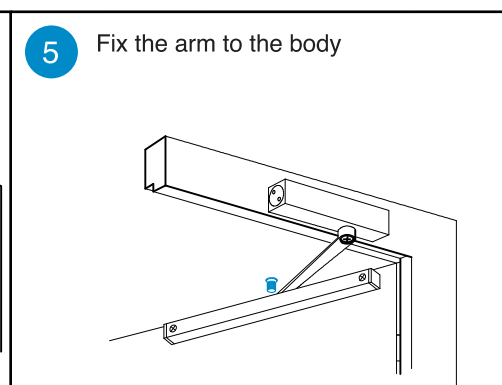
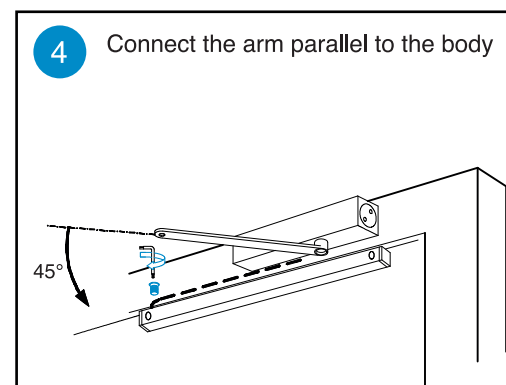
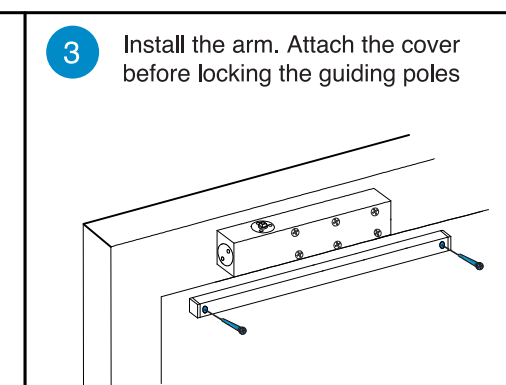
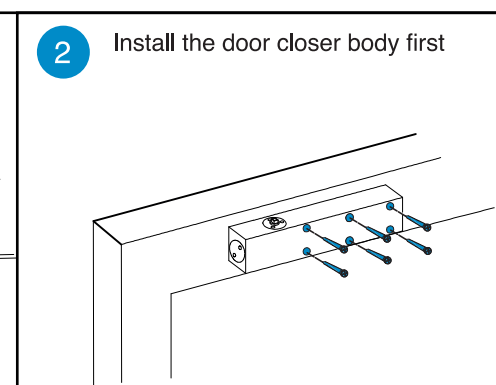
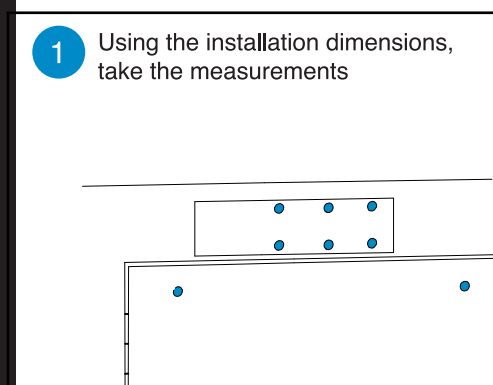
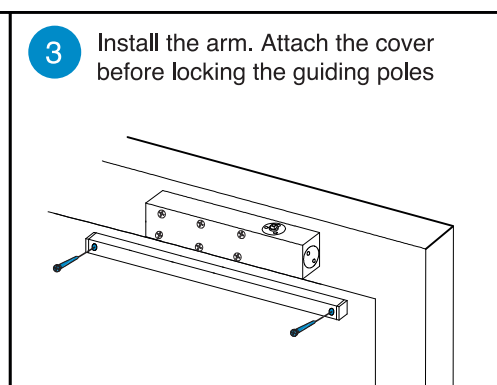
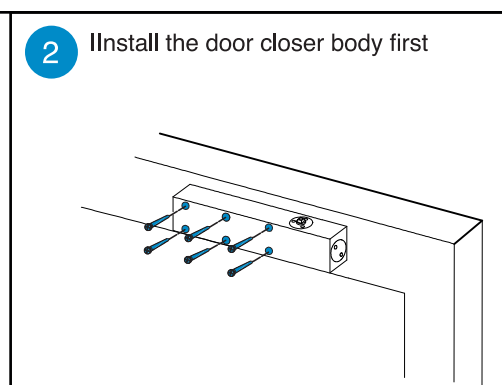
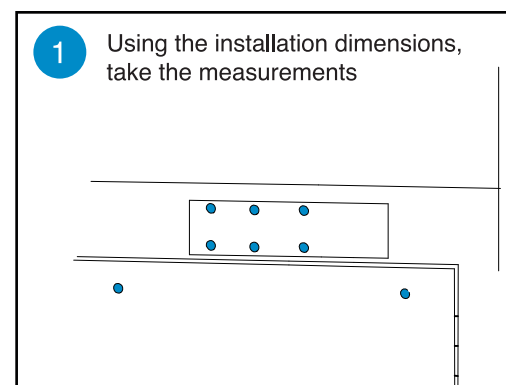

BC	Slowdown during opening
1	Speed of closing
2	Finishing blow

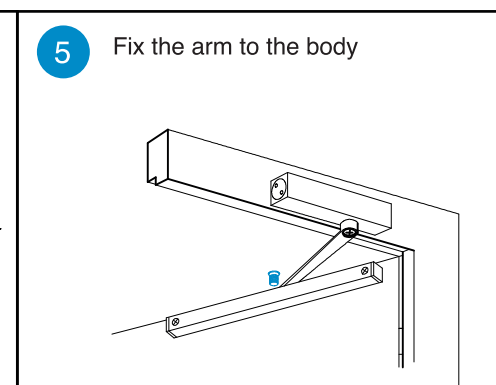
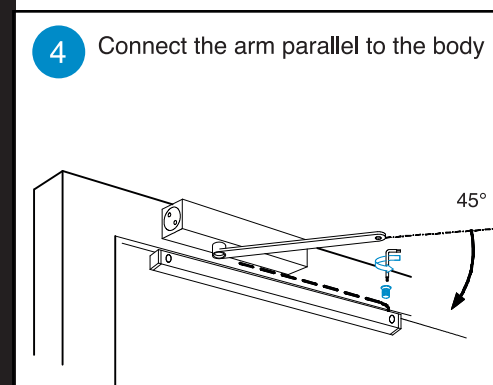

BC	Slowdown during opening
1	Speed of closing
2	Finishing blow

### ADJUSTMENTS

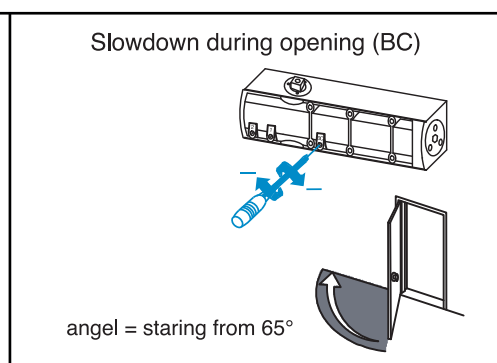
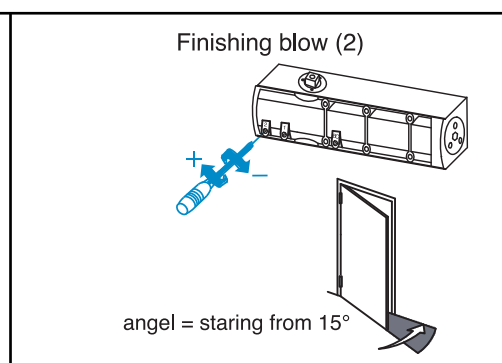
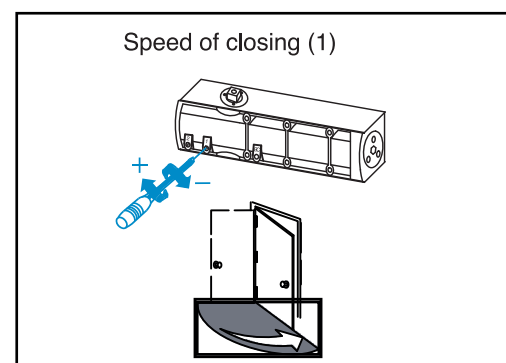

### ADJUSTMENTS

